

LFP12-20

Physical Dimensions

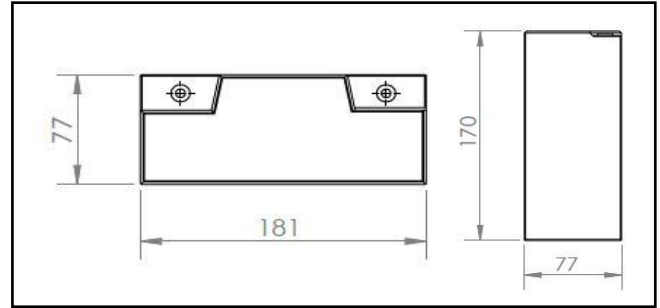
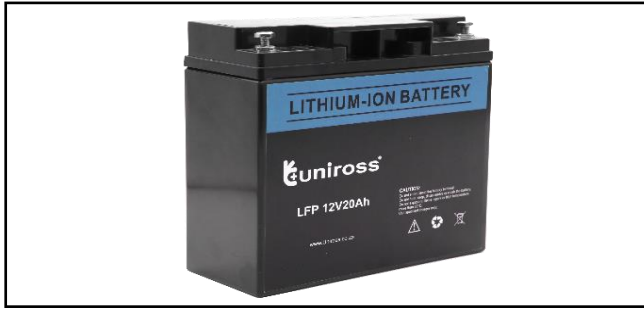

Electrical Characteristics	Nominal Voltage	12.8V
	Rated Capacity	20Ah
	Typical Capacity	18.66Ah
	Energy	256Wh
	Internal Resistance	≤150mΩ
	Cycle Life	>2000 cycles at 0.2C 80% DOD
	Months Self Discharge	<3%
Charge	Charge Voltage	14.4+/-0.2V
	Charge Mode	CC at 0.2C to 14.4V, CV14.4V stop current = 0.02C
	Charge Current	4A
	Max. Charge Current	20A
	Charge cut-off voltage	15.6V+/-0.2V
Discharge	Max. Continuous Current	20A
	Max. Pulse Current	20A
	Discharge cut-off Voltage	8V
Environment	Charge Temperature	0°C to 45°C at 60±25% Relative Humidity
	Discharge Temperature	- 20°C to 60°C at 60±25% Relative Humidity
	Storage Temperature	0°C to 40°C 60±25% Relative Humidity
	Ingress Protection	IP56
Mechanical	Cell Material	LiFePO4
	Plastic Case Material	ABS
	Dimensions (mm)	181*77*170mm
	Weight (Kg)	2.3KG
	Terminal	M5
BMS	Protection Function	Over charge, Over discharge, Over current, Short Circuit, Cell Balancing function, Temperature protection

Discharge Characteristics

